

TUMBLER CC

Firefighting and Emergency Vehicle

| Fire Response |



TRIGEN



SPEC A | Ford Chassis |



SPEC B | Isuzu Chassis |



SPEC A | Ford Chassis

TUMBLER CC

Tumbler CC is a closed cabin firefighting vehicle equipped with state-of-the-art capabilities to meet the demands of rapid response to fire emergencies in an urban environment. The nimble vehicle has the capability to provide sufficient knock-down power to take on residential and industrial fires while obtaining its water source from a hydrant, fire engine or water body, complementing the larger fire engine.

With a small-sized truck as the vehicle platform, Tumbler CC can be configured with different fire pump options to suit different firefighting scenarios and the rear compartment is customisable to fit required equipment.



SPEC B | Isuzu Chassis



1

Pump controls for 500 GPM fire pump

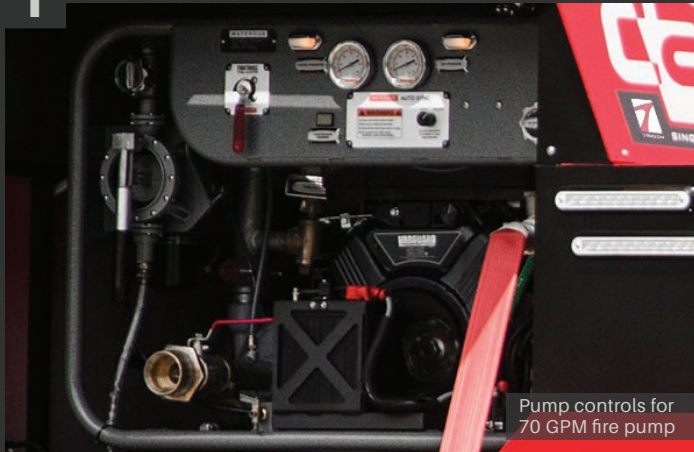

Pump controls for 70 GPM fire pump

2



1 Fire pump

Fire pump options include a 500 gallons per minute (GPM) unit that uses an external water source or a 70 GPM pump that works with an onboard 250-litre water tank. Compressed Air Foam System (CAFS) is also available to work with the water pumps.

Water	CAFS	
500 GPM fire pump		
500 GPM @ 150 psi 350 GPM @ 200 psi 250 GPM @ 250 psi	440 GPM/ 220 CFM @ 125 psi	
70 GPM fire pump		
70 GPM @ 100 psi		35 GPM/ 35 CFM @ 100 psi

*psi = pounds per square inch

2 Proprietary controller

With the 500 GPM fire pump option, a proprietary controller is equipped onto Tumbler CC to make it simple for the operator to switch the power take-off (PTO) from driving to pumping mode. Once in pumping mode, the vehicle becomes a powerful firefighting tool with its PTO-driven fire pump.

3

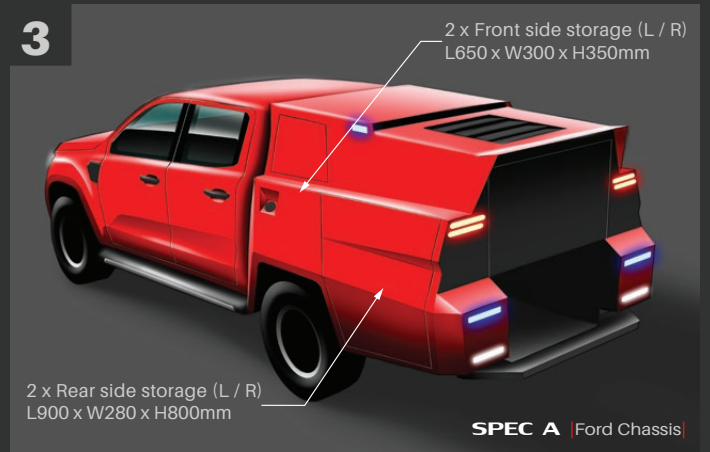

4

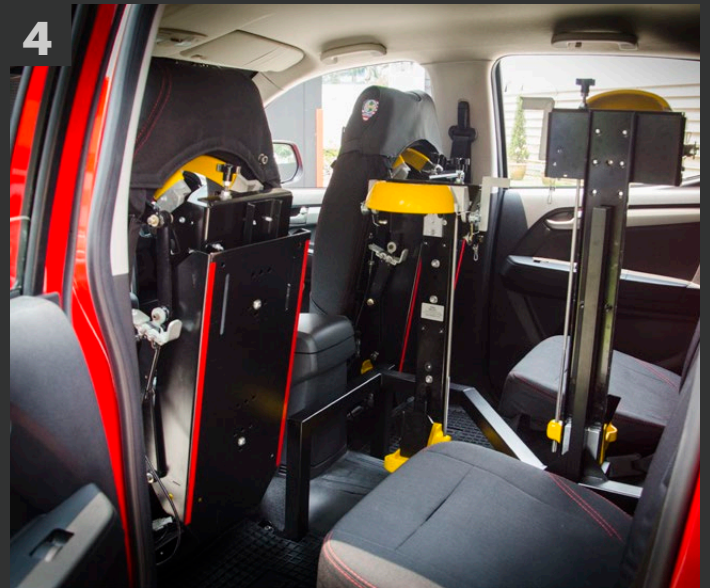

5



3 Customisable rear compartment

Depending upon your requirements, the rear compartments can be customised to house your firefighting equipment in the best possible manner.

4 Redesigned interior

The interior seats are redesigned, making placing and retrieving essential breathing apparatus an easy process.

5 2WD/ 4WD

Selectable two-wheel or four-wheel drive operation, depending on your road conditions.

Specifications

Chassis	Ford Ranger	Isuzu D-Max
Seating capacity	4 persons (including driver)	4 persons (including driver)
Dimensions (L x W x H)	5,700 x 2,000 x 1,900mm	5,400 x 1,900 x 2,000mm
Gross weight	3,200 kg (as per chassis OEM specifications)	3,000 kg (as per chassis OEM specifications)
Unladen weight	2,500 kg	2,400 kg
Engine type	3.2L Duratorq TDCi Puma	2.5L twin turbo diesel engine (4JK1)
Max. Output / Torque	197hp / 470Nm	163hp / 400Nm
Emission standard*	Euro 5	Euro 5
Transmission	6-speed automatic transmission (6R80)	5-speed automatic with selectable 2WD/ 4WD/ 4WD-L
Minimum turning radius	6.3m	6.3 m
Steering	Electric power assisted (rack and pinion)	Rack and pinion assisted, collapsible
Front/ rear brakes	Front ventilated discs/ rear drum brakes	Front disc brakes/ rear drum brakes

* Other regulated emission standards are also available according to region specific regulations

Customisation options

Foam tank capacity	20 - 100 L
Foam ratio	0-6%
Water pump	70 / 500 GPM
Compressed air foam system	Available
Storage compartments	Customised to fit required equipment
Deck gun	Available
Winch	4,000 kg pull force single-line
Scene lights	Available
Bumper with trailer hitch	Available

SPEC A |Ford Chassis|

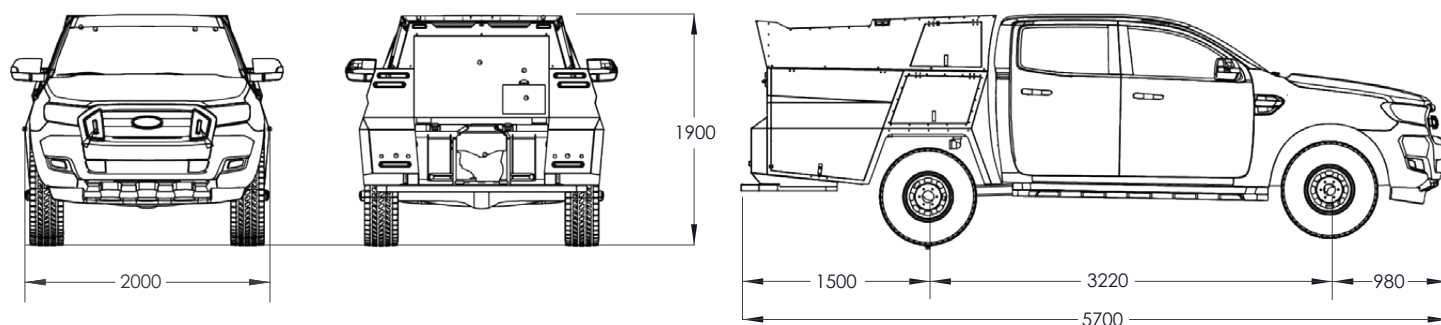

SPEC B |Isuzu Chassis|

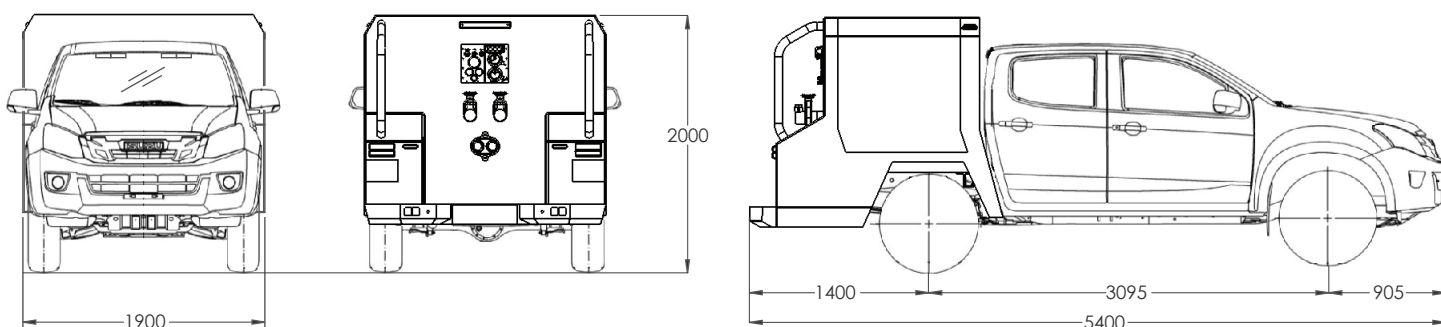

TRIGEN Automotive
(a division of HOPE Technik)

6 Penjuru Close Singapore 608614
T (65) 6877 0193 | F (65) 6877 0693
E sales@trigenautomotive.com
trigenautomotive.com

© 2018, HOPE Technik Pte Ltd, All rights reserved.
No part of this brochure may be reproduced, stored in a retrieval system or transmitted in any form or by any means, electronic, mechanical, photocopying, recording or otherwise, without prior written permission from HOPE Technik. Whilst every reasonable effort has been made to ensure that the content of this brochure is correct at the time of printing, HOPE Technik does not warrant that the information is free from errors or omission. HOPE Technik reserves the right to make any adjustments to the information contained herein at any time without notice.